



EAN code - DEVICE: ATR: 8595188125000  
 ATF: 8595188130165  
 ATC: 8595188130172  
 To devices is necessary to order additionally - frame in design ELEGANT and external sensor (except ATR)

EAN code - SET: ATR, white frame Elegant: 8595188136228  
 ATF, white frame Elegant, termosensor TC-3m: 8595188135870  
 ATC, white frame Elegant, termosensor TC-3m: 8595188135887

Technical parameters	ATR	ATF	ATC
<b>Supply</b>			
Power supply and tolerance:	AC 230 V ± 10 %		
Consumption, frequency:	6.5 VA / 50 - 60 Hz		
<b>Measuring</b>			
Temperature range:	5 to 40°C (41 °F to 104 °F)	5 to 50 °C (41 °F to 122 °F)	
Accuracy:	± 2 °C / 36 °F		
Hysteresis:	± 1 °C / 34 °F		
Temperature sensor:	room	floor	room + floor
Night decline:	adj. ± 7 °C / 45 °F	adj. ± 10 °C / 50 °F	fix - 5 °C / 41 °F
Offset / calibration:	adj. ± 7 °C / 45 °F		adj. ± 10 °C / 50 °F
<b>Setting</b>			
Room temperature setting:	main knob	x	main knob
Floor temperature setting:	x	main knob	auxiliary button 2
Offset setting:	auxiliary button 1		
Night decline setting:	auxiliary button 2		x
Night decline switching:	internal / external	internal pushbutton	
<b>Display</b>			
Power supply indication:	green LED 1		
Output ON indication:	red LED 1		
Night decline indication:	red / orange LED 2	red LED 2	
Indication of faulty floor sensor:	x	LED 1 flashing	
Indication- exceeded temp. / ext. sensor:	x		LED 1 flashing
<b>Output</b>			
Type:	potential-free contact NO-SPST, material of contact - AgNi		
Max. loadability:	16 A / 250 V, 4000 VA for AC1		
Contact separation:	galvanic		
Mechanical life:	3x10 <sup>7</sup>		
Electrical life (AC1):	0.7x10 <sup>5</sup>		
<b>Other information</b>			
Operating temperature:	-10 °C to 55 °C (14 °F to 131 °F)		
Storage temperature:	-20 °C to 70 °C (-4 °F to 158 °F)		
Electrical strength:	4 kV		
Mounting:	installation box with min. depth 30 mm / 1.18", Ø min. 65 mm / 2.6"		
Protection degree:	IP30 in standard conditions*		
Max. cable size (mm <sup>2</sup> ):	solid wire 1x 2.5 / 1.5 with sleeve (AWG 12)		
Dimensions:	84 x 89 x 56.4 mm (3.3" x 3.5" x 2.22")		
Weight:	110 g (3.9 oz.)		
Standards:	EN 60730-2-9, EN 61010-1		

\* see page 41

- **ATR - Analog Thermo Room:**
  - Room thermostat with temperature range 5 to 40 °C (41 °F to 104 °F) with a built-in sensor.
- **ATF - Analog Thermo Floor:**
  - Floor thermostat with temperature range 5 to 50 °C (41 °F to 122 °F) with external sensor.
  - Function „temporary temperature change“ in range ±10 °C (50 °F) (decreasing / increasing temperature).
- **ATC - Analog Thermo Combined:**
  - Room and floor thermostat, sensors are connected in series and block each other.
  - Function „temporary temperature change“; fix -5 °C / 23 °F (night decline).
  - Temperature range 5 to 50 °C (41 °F to 122 °F) for both sensors, adjustable separately.
  - It is possible to use it without external sensor.
- **ATR, ATF, ATC**
  - Night decline is activated by a pushbutton on device or external contact (only ATR).
  - Night decline setting is done by an auxiliary button 2 (under main button, only ATR/ATF).
  - Offset setting (calibration ± 10 °C / 50 °F) with „known“ thermometer.
  - External sensor (TC-3. 3 m / 9.84') is a part of delivery (only ATF/ATC), it is possible to extend its length up to 100 m (328').
  - Design ELEGANT, wide range of colors, possibility to combine more frames together.

**Description**

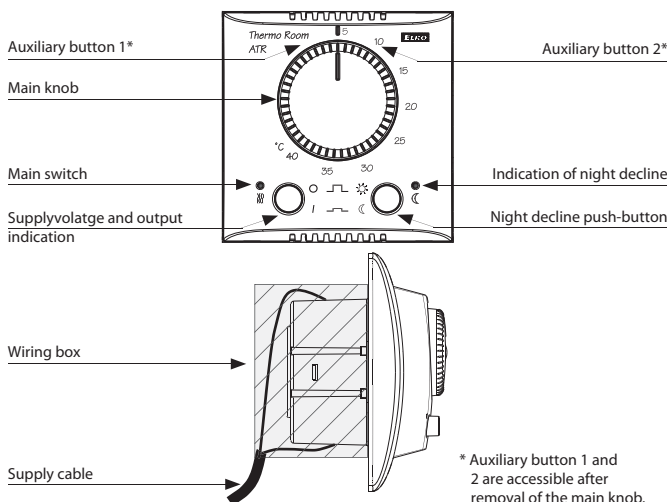

**Connection**

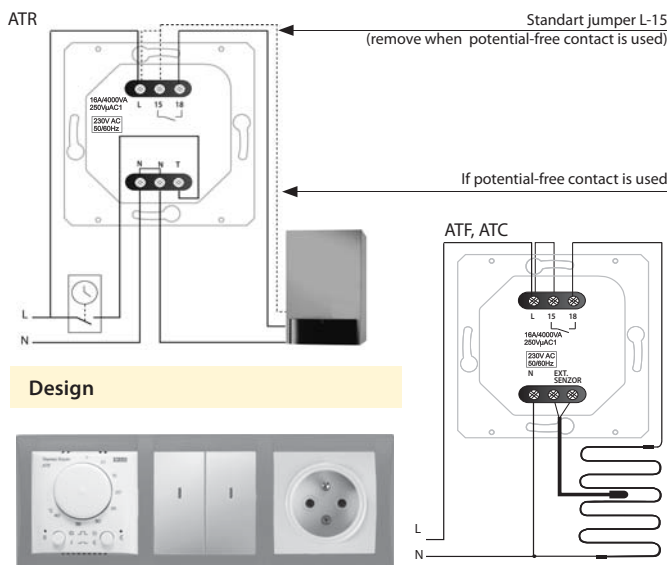

**Design**





Complete offer of switching devices line ELEGANT can be found in an individual catalogue ELEGANT Home switches, which can be sent to you upon request.

Type	Design	Supply voltage	Type of dimmed load						Output unit	Output			Method of phase regulation		Control principal 0-10 V / 1-10V	Designation	Catalogue page
			R resistive el. bulbs, halogen lights)	L inductive (wound transformers)	C capacitive (electronic transformers)	ESL energy-saving fluorescent lamps	LED <sup>1,2</sup> LED lamps	Rated load			ON-DIMMER	OFF-DIMMER					
								R		L			C				
DIM-2	1M-DIN	AC 230 V	●	●	x	x	●	triac	10-500 VA*	10-250 VA	x	●	x	x	Stairway automaton with progressive illumination on / off, adjustable rise time, delay, deceleration, maximum brightness. Dimmer R, L, LED1.	42	
DIM-5	1M-DIN	AC 230 V	●	●	x	x	●	triac	10-500 VA*	10-250 VA	x	●	x	x	Universal dimmer R, L, LED <sup>1</sup> , button control.	43	
DIM-14	1M-DIN	AC 230 V	●	●	●	x	●	2x MOSFET	500 VA*	500 VA*	500 VA*	●	●	x	Universal dimmer R, C, L, LED <sup>2</sup> , button control, automatic switching of the dimming mode according to the connected load	48	
DIM-15	1M-DIN	AC 230 V	●	●	●	●	●	2x MOSFET	300 VA	300 VA	300 VA	●	●	x	Universal dimmer R, C, L, ESL, LED <sup>2</sup> , button control,	46	
DIM-6	6M-DIN	AC 230 V	●	●	●	x	●	4x MOSFET	2 000 VA*	2 000 VA*	2 000 VA*	●	●	●	Universal dimmer 2kW R, C, L, LED <sup>2</sup> , power expandable, pushbutton control / 0-10V / 1-10V / potentiometer / INELS bus.	44	
DIM6-3M-P	3M-DIN	AC 230 V	●	●	●	x	●	2x MOSFET	1 000 VA*	1 000 VA*	1 000 VA*	●	●	x	Expansion power module 1kW to DIM-6 dimmer.	45	
SMR-S	BOX	AC 230 V	●	●	x	x	●	triac	10-300 VA*	10-150 VA	x	●	x	x	Like DIM-5, but for mounting under the push-button into the installation box (e.g. KU-68).	49	
SMR-U	BOX	AC 230 V	●	●	●	x	●	2x MOSFET	500 VA*	500 VA*	500 VA*	●	●	x	Like DIM-14, but for mounting under the push-button into the installation box (e.g. KU-68).	49	
SMR-M	BOX	AC 230 V	●	●	●	●	●	2x MOSFET	160 VA	160 VA	160 VA	●	●	x	Like DIM-15, but for mounting under the push-button into the installation box (e.g. KU-68).	46	
LIC-1	1M-DIN	AC 230 V	●	●	●	●	●	2x MOSFET	300 VA*	300 VA*	300 VA*	●	●	x	Universal dimmer R, C, L, ESL, LED <sup>2</sup> , button control, constant light level control.	50	
LIC-2	1M-DIN	AC 100-250 V	x	x	x	x	x	x	x	x	x	x	x	●	Controller for dimmers or electronic ballasts with 0-10 V / 1-10V control, button control, constant light level control.	51	

\* with load over 300 VA is necessary to ensure sufficient cooling

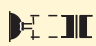
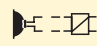
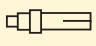
Key to symbols

TYPE OF LOAD (symbols)	bulbs, halogen lamps	low-voltage el.bulbs 12/24V wound transformers	low-voltage el.bulbs 12/24V electronic transformers	ESL dimmable compact fluorescent lamps	Dimmable LED bulbs
	 R	 L	 C	 ESL	 LED <sup>1,2</sup>

Demonstrated symbols are informative

Expansatory:



Dimmer with designated load:

R - resistive

L - inductive

C - capacitive

ESL - energy saving bulbs

LED<sup>1</sup> - dimmable LED bulbs, designed for dimmers with phase-controlled rising edge (triac dimmers)

LED<sup>2</sup> - dimmable LED bulbs designed for dimmers with phase or phase-to-phase phase control (dimmers with MOSFET)

IPxx protection - under normal conditions: normal conditions are understood as such conditions of operating an electrical device, installation and power supply network for which the entire device is designed, produced and installed. Upon these normal conditions of use and upon normal maintenance, all protective devices must be effective throughout the entire expected service life of the product.

Recommendation for mounting modular dimmers: leave a gap of min. 0.5 module (approx. 9 mm / 0.4") on side of the device to ensure better cooling of the device.